

This is Appendix B to the Agreement for Supply of Electricity- Wholesale Service between FortisBC and City of Kelowna

2004/05 Boundary Adjustments

City of Kelowna have adjusted the service boundary due to Aquila/FortisBC servicing new developments on Denali Dr. just off Summit Dr.(estimated 12 lots) and new development East on Spruce view Pl. South, including Markham Ct, Marona Ct and Spruce view Ct.(estimated 34 lots) that were originally in the City's service area prior to 2004.

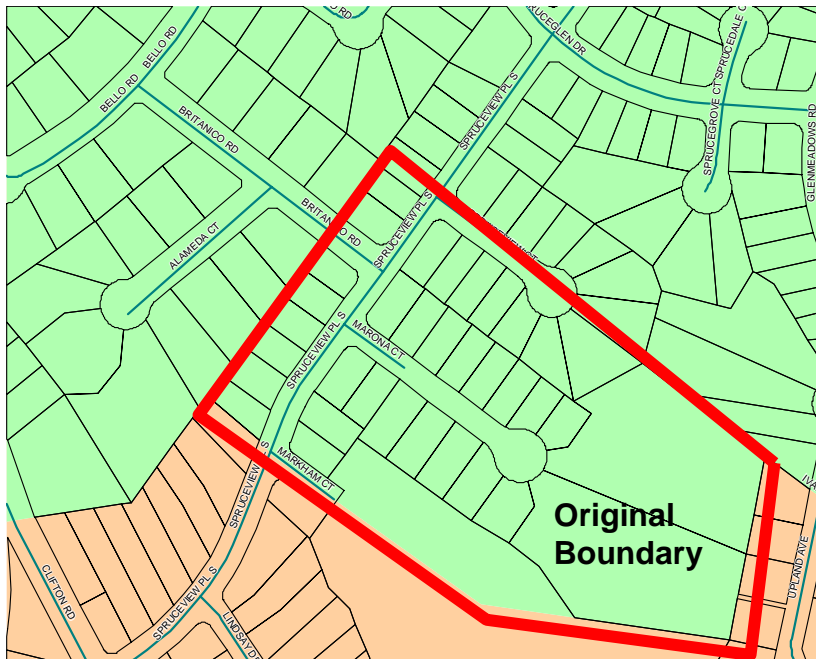

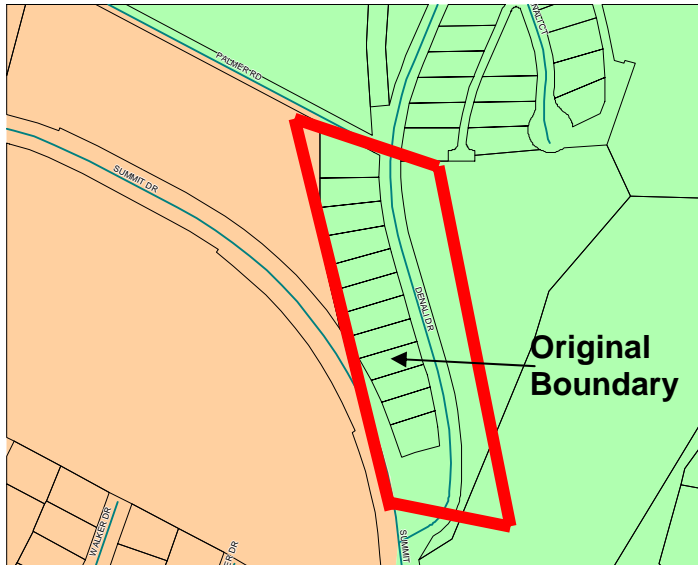

An interim boundary map has been inserted into the Agreement ForThe Supply OF Electricity Whole – Sale Service (dated November 1st, 2004) and will be adjusted after the future development occurs.

CITY OF KELOWNA INTERIM SERVICE AREA

